

**PRODUCT DEFINITION:**

Acoustic panel with grooves on wieved face and holes at back side. Soundtex black glass tissue applied to back face. Various color options available on all visible surfaces. Used for interior applicants in general building and civil engineering structures.

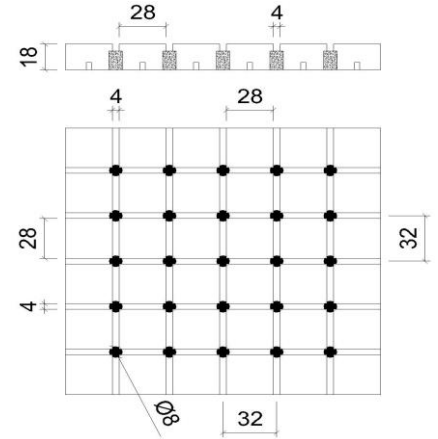
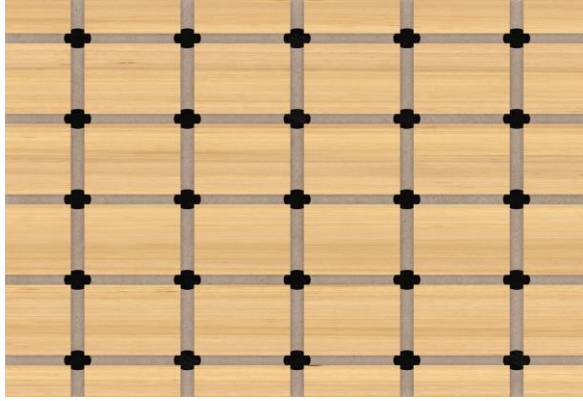

| FREQUENCY(HZ)                |              | 100  | 125  | 160  | 200  | 250  | 315  | 400  | 500  | 630  | 800  | 1000 | 1250 | 1600 | 2000 | 2500 | 3150 | 4000 | 5000 |
|------------------------------|--------------|------|------|------|------|------|------|------|------|------|------|------|------|------|------|------|------|------|------|
| SOUND ABSORPTION COEFFICIENT | Plenum 200mm | 0,31 | 0,37 | 0,35 | 0,37 | 0,39 | 0,41 | 0,41 | 0,44 | 0,41 | 0,42 | 0,38 | 0,41 | 0,38 | 0,35 | 0,35 | 0,38 | 0,43 | 0,48 |
|                              | Plenum 63mm  | 0,32 | 0,40 | 0,42 | 0,42 | 0,44 | 0,43 | 0,45 | 0,48 | 0,43 | 0,44 | 0,42 | 0,39 | 0,36 | 0,36 | 0,36 | 0,39 | 0,40 | 0,48 |

**ACOUSTIC FEATURES:**

|                               |       |
|-------------------------------|-------|
| Distance Between Grooves (mm) | 28    |
| Width Of Groove (mm)          | 4     |
| Depth Of Groove (mm)          | 6     |
| Diameter Of Hole (mm)         | 10    |
| Pitch Of Hole (mm)            | 32x32 |
| Depth Of Hole (mm)            | 15    |
| Perforated Area (%)           | 4     |

**ACOUSTIC VALUES**

|                       |            |                   |
|-----------------------|------------|-------------------|
| <b>Mounting Depth</b> | <b>NRC</b> | <b>Euro Class</b> |
| Plenum 63 mm          | 0,45       | D                 |
| Plenum 200 mm         | 0,40       | D                 |
| Mineral Wool          | 50 mm      | 50 kg/m3          |

Absorption according to EN ISO 354

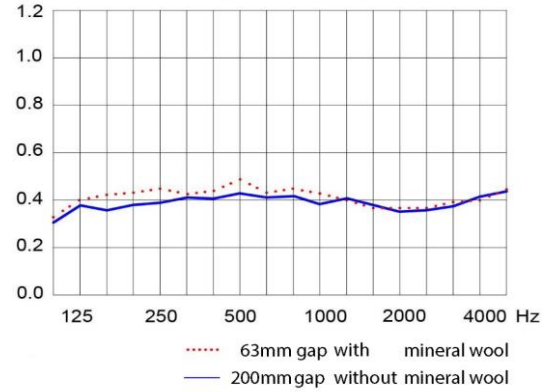

**GENERAL FEATURES:**

|                    |  |
|--------------------|--|
| Materials          | MDF Standart D-s2.d0<br>MDF Fire Resistant B-s2.d0   |
| Thickness (mm)     | 18mm (MDF)<br>For other materials and thicknesses, please contact with PERFOPAN                        |
| Approximate Weight | 13,45 kg/m2 18mm Standart MDF      14,60 kg/m2 18mm Fire Resistant MDF                                 |
| Finishing          | Melamine      Wood Veneered      High Pressure Laminate (HPL)<br>Varnished      Lacquered to RAL Chart |

**Sizes**

| Mounting Type: Aluminium Profile | FR Class | D Class  |
|----------------------------------|----------|----------|
| Melamine                         | 512x1390 | 512x1390 |
|                                  | 672x1390 | 672x1390 |
|                                  | 512x2780 | 512x2780 |
|                                  | 672x2780 | 672x2780 |
|                                  |          | 576x1800 |
| HPL                              | 512x1390 | 512x1390 |
|                                  | 672x1390 | 672x1390 |
|                                  | 512x2780 | 512x2780 |
|                                  | 672x2780 | 672x2780 |
|                                  |          | 576x1800 |
|                                  | 576x3640 | 576x3640 |

| Mounting Type: Aluminium Profile | FR Class | D Class  |
|----------------------------------|----------|----------|
| Veneered                         | 512x1390 | 512x1390 |
|                                  | 672x1390 | 672x1390 |
|                                  | 512x2780 | 512x2780 |
|                                  | 672x2780 | 672x2780 |
|                                  |          | 576x1800 |
| Lacquered                        | 512x1390 | 512x1390 |
|                                  | 672x1390 | 672x1390 |
|                                  | 512x2780 | 512x2780 |
|                                  | 672x2780 | 672x2780 |
|                                  |          | 576x1800 |
|                                  | 576x3640 | 576x3640 |